

Full manual:
<http://support.ludafarm.com/>

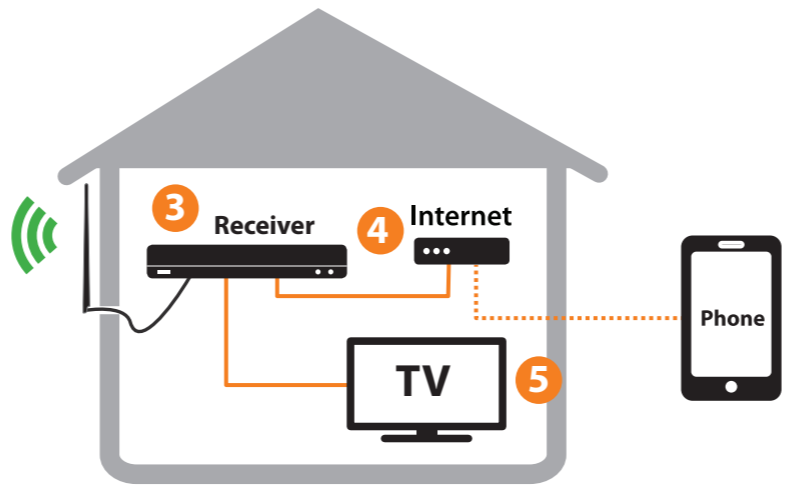
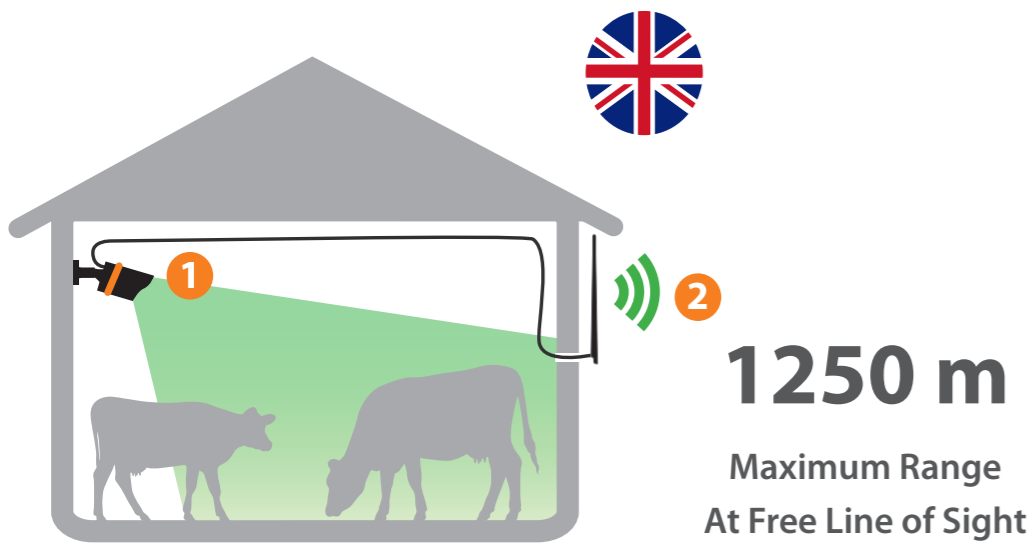

HOW IT WORKS

- 1 The camera monitors your animals. The signal is transmitted through the cable (9-18m) to the outdoor antenna.
- 2 The signal is sent wirelessly to the office/home.
- 3 The receiver receives the signal through its outdoor antenna connected with cable (9-18m).
- 4 By connecting the receiver to your internet router you can see your animals/barn/buildings/farm wherever you go, using any smartphone, tablet or computer connected to the internet.
- 5 By connecting the receiver to your TV you can see the camera picture there as well!

INCLUDED IN THE BOX

- x1
Receiver (4 channel)
Art.No. 1076
- x1
IP Camera
Art.No. 1077
- x1
Receiver Power Adapter
Art.No. 6054
- x1
Camera Power Adapter
Art.No. 6055
- x1
2 m HDMI Cable
Art.No. 5036
- x1
18 m Power Extension Cable
Art.No. 5035
- x1
1 m Ethernet Cable
Art.No. 5037
- x1
USB Mouse
Art.No. 7036
- x2
Large Antennas
Art.No. 5033
- x3
Small Antennas
Art.No. 5038
- x3
9 m Antenna Cables
Art.No. 5034
- x1
Shrinkable Tubing
Art.No. 7037

INSTALLATION

- A** Mount the large outdoor antennas vertically as illustrated below. Place them at the same height and avoid any nearby metal objects.
- B** Connect the antennas to camera and receiver using the 9 m antenna cables. Connect the camera to power. Water-proof the camera power connector using the shrinkable tube.
- C** Connect the receiver to power. The system will setup automatically.

TIP!

Use the small antennas on camera and receiver when the distance between them is short.

Use the included extra 9 m antenna cable if needed on either the camera or receiver side.

Avoid obstacles (trees, bushes, buildings) between the outdoor antennas, to obtain a **Free Line of Sight** = The best signal quality.

TV installation? START HERE!

1 Connect the tv and mouse to your receiver.

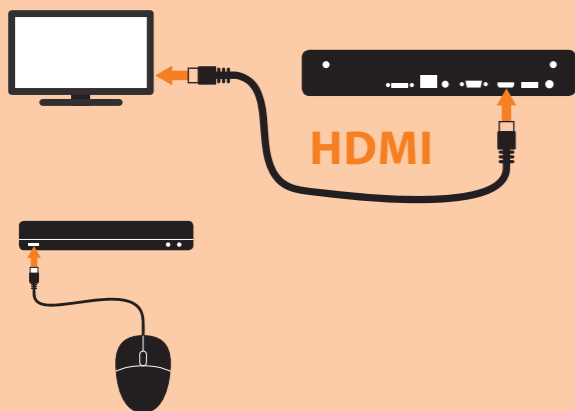

2 a) Choose the HDMI-channel on your tv
b) Choose your password (minimum 6 letters). **NOTE!** You must remember the password to log in if you do not choose to tick the checkbox
c) Click on the button to save and continue

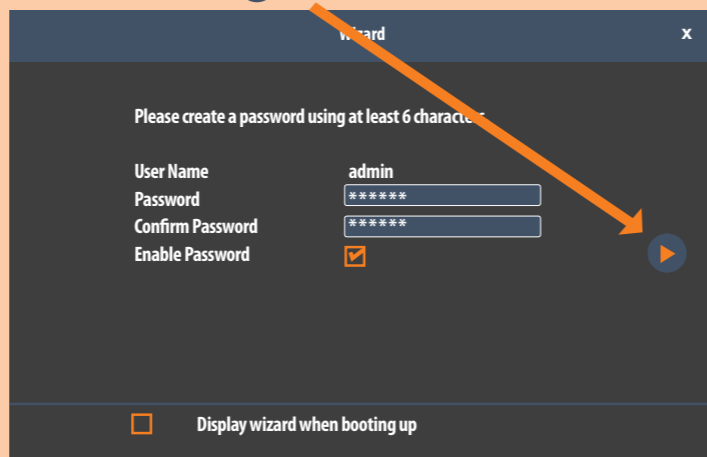

NOTE! You can write down your password in the field below

.....

3 a) Choose your language
b) Click on the button to save and on x to finish*

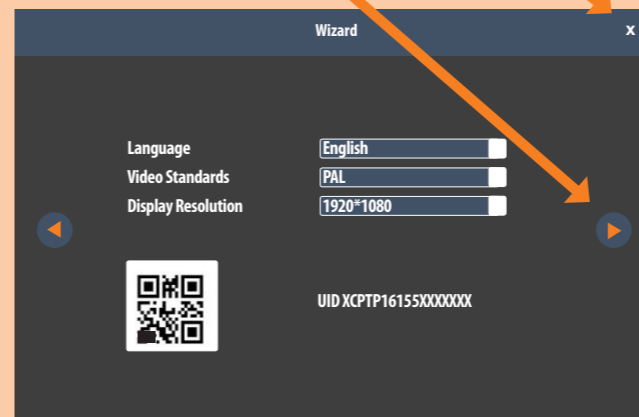

*= this is enough to get going with your FarmCam HD. You can do more settings at a later stage.

4 a) **DOUBLE-CLICK** on the image to get it in full screen
b) **RIGHT-CLICK** to see the options:



c) **YOU'RE DONE** with the quick setup of FarmCam HD on your tv!

If you want to see the picture on your mobile or pc, continue to step 5.

SmartPhone installation only? START HERE!

5 Connect the receiver to your broadband router using the ethernet cable.

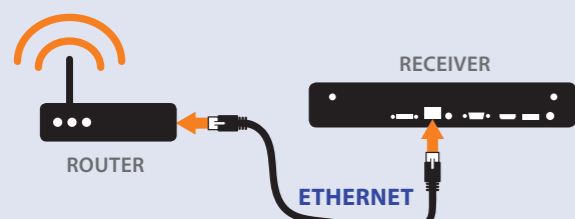

1 m cable is included. If you need a longer cable you can easily find it in most stores carrying electronics.

6 Make sure your mobile is using the same Wi-Fi/network as your receiver

7 a) Download and install the FarmCam HD app from Appstore or Google play



b) Open the app:
c) Allow notifications (iPhone only)



8 If you have you not done the installation on tv, skip step 9-10 and proceed to step 11.

9 a) Press:
b) Press:

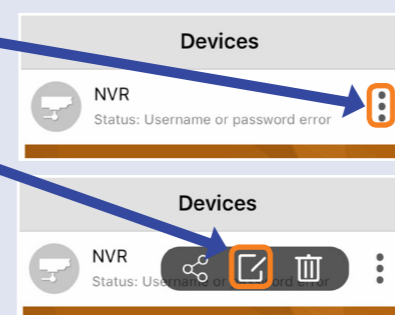

10 a) Choose the same password as on the tv

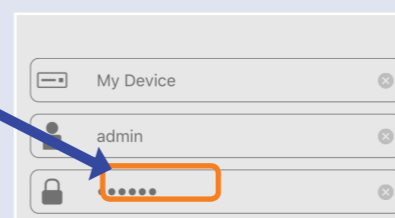

b) Press save



11 Press to see video

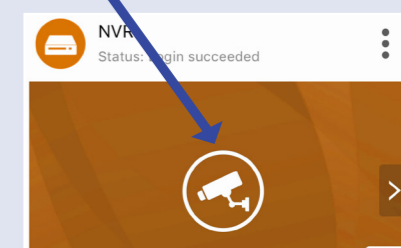

12 1 MIN REGISTRATION = 1 YEAR EXTRA WARRANTY Register your farmCam HD and get 3 years warranty.

Go to: www.luda.farm/warranty-register

To download pc-software and read about how to get going with FarmCam HD on your computer,

go to:
www.luda.farm/farmcamHD

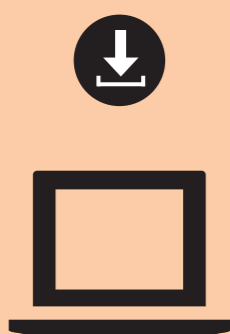

HOW IT WORKS

How the app works

1. Access to devices
2. Live view
3. Play/stop
4. Sound on/off
5. Take snapshot (to mobile)
6. Record video (to mobile)
7. Amount of camera views
8. Video quality
9. Full screen
10. Playback mode

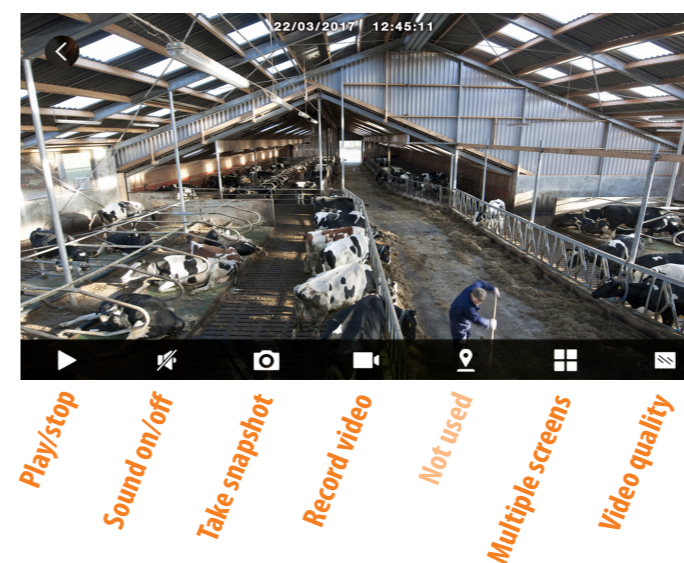
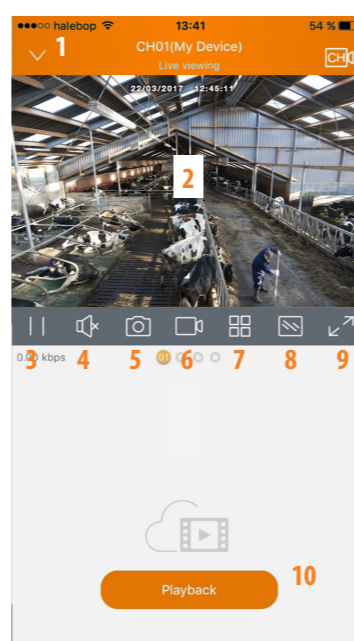

Technical Specifications:

2,4GHz Wireless Camera

Frequency Bands:
802.11b/g/n(20MHz):2412-2472MHz
802.11n(40MHz):2422-2462 MHz
Modulation Mode: CCK7OFDM7DBPSK7DAPSK
Wireless Range: 1250 m with 9dBi antenna
Resolution: 1920 x1080p
Video Frame Rate: 15fps @ 1080p
Angle of View: 90°
IR night range: 30 Meters
Image Sensor: 1/3" 1080P CMOS
Microphone: Embedded mic
Operating frequency: 2422-2462MHz
Power Supply adapter: 100-240V
Power to camera: DC12V -1A
Operating temperature: -20 °C~+55 °C
IP classification: IP66
Dimensions: Ø70 x 190mm

2,4GHz Wireless Receiver NVR

Frequency Bands:
802.11b/g/n(20MHz):2412-2472MHz
802.11n(40MHz):2422-2462 MHz
Modulation Mode: CCK7OFDM7DBPSK7DAPSK
Resolution: Full HD 1080P
Maximum Cameras: 4
Hard Drive included: 1 TB
Video output: HDMI & VGA
Audio output: RCA
Network Interface: RJ 45 Ethernet
Supported systems: Android, Iphone, MAC & PC
Power Supply adapter: 100-240V
Power to receiver: DC12V - 2A
Operating temperature: -10°C~+55°C



Luda.Farm AB,
Krokslätts Fabriker 30,
431 37 Mölndal/Sweden